

# JUUNOO SPEC SHEET

## DEMOUNTABLE WALL



### FRAMING

Juunoo modules are made from S250GD – galvanised steel. Our guarantee to you is that at least 40% of this steel comes from recycling processes. All modules are composed of 2 telescopic pieces that can be infinitely adjusted. The vertical modules (I & C) have a ‘Quickspan’ lever that tensions and fixes the stud in place when closed.

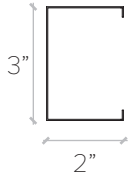

**C - module**

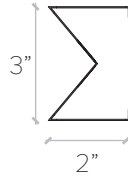

**I - module**

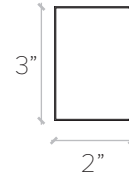

**D- module**

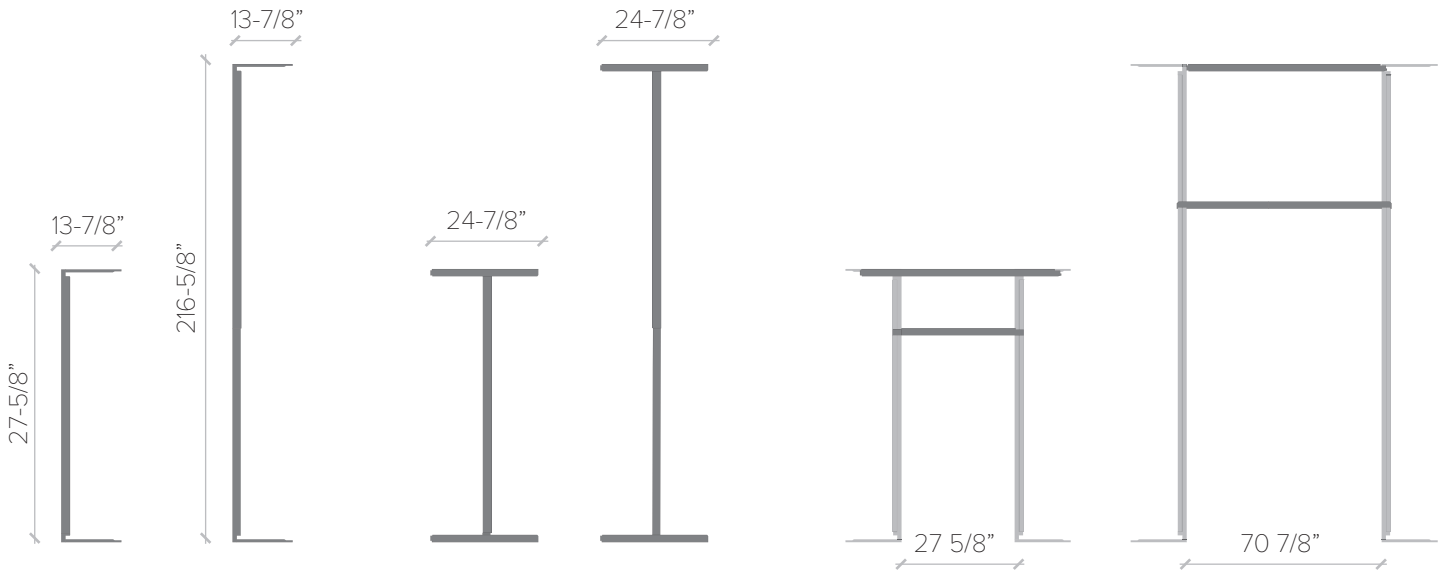

### HEIGHT RANGES

- S = 27 5/8" - 47 1/4"
- M = 63" - 110 1/4"
- L = 78 3/4" - 137 7/8"
- XL = 118 1/8" - 216 5/8"

### OPENING WIDTHS

- MIN = 27 5/8"
- MAX = 70 7/8"

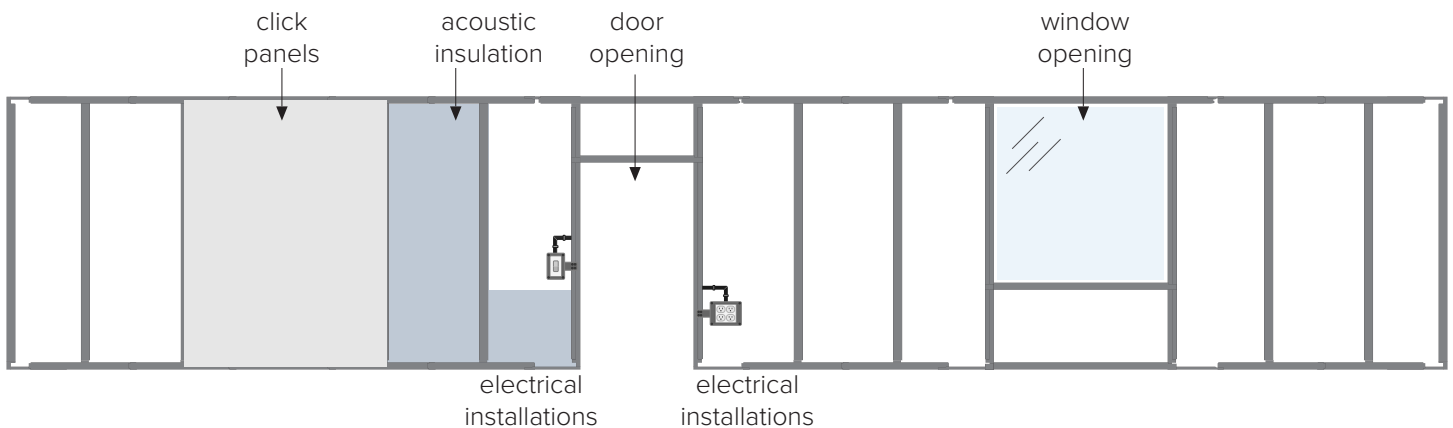

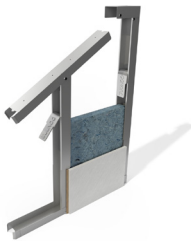

**JUUNOO SPEC SHEET**  
DEMOUNTABLE WALL



**CLICK PANEL**

The structure is preferably covered with click panels. They have a melamine finish that is available in many decors. The panels are clicked in one another by their seamless tongue and groove connection. The panels are adhered to the modules with the JuuNoo-tapes.

**mechanism**

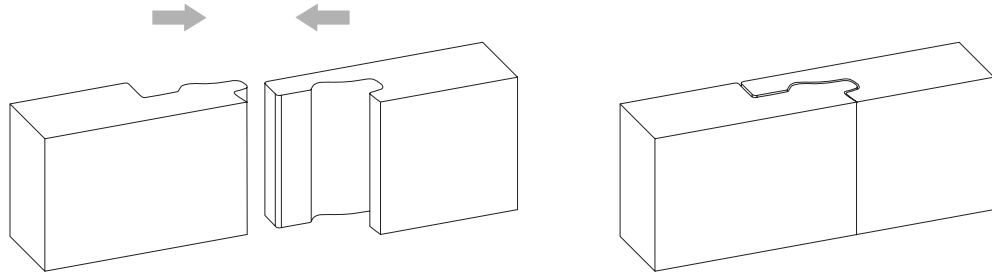

**vertical section**

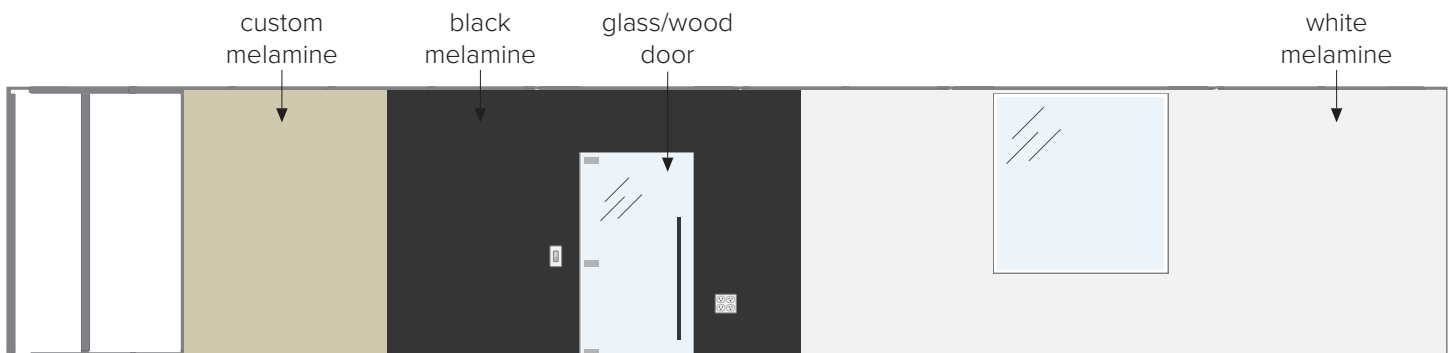
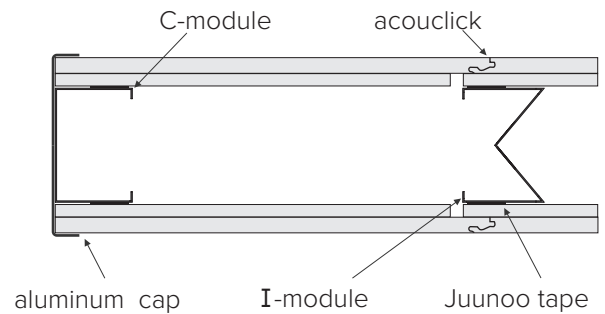
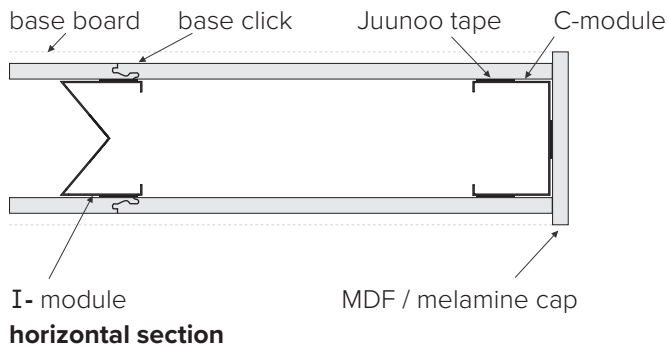
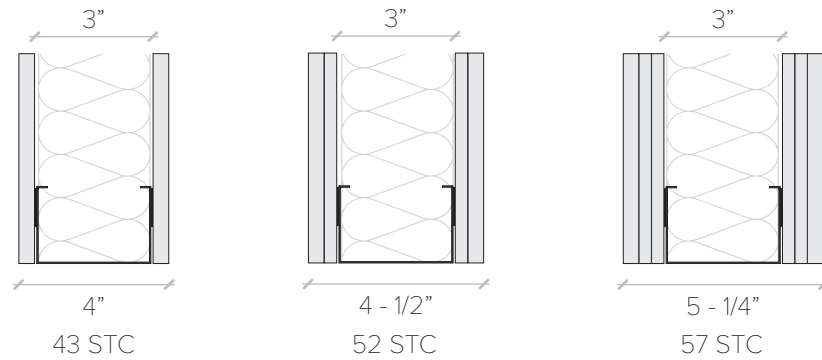

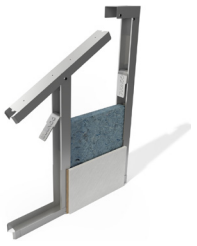

**JUUNOO SPEC SHEET**  
DEMOUNTABLE WALL



**CLICK PANEL STANDARD FINISHES**

Unilin melamine finishes

12 standard colors/patterns available in stock. Others available upon request

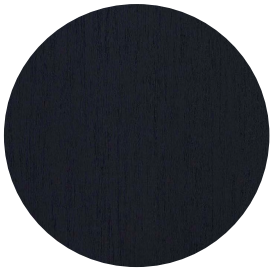

**Elegant Black**



**Front White**



**Fakewood Light**



**Oak Light Natural**



**Light Oak Patina**



**Oak Vanille**



**Oak Brown**



**Concrete Light**

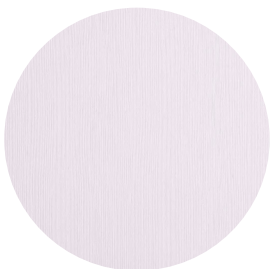

**Linewood Light**



**Seashell**

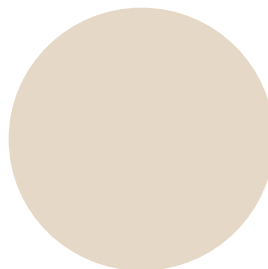

**Dune Beige**



**Silicon**